

# INGROUND SERIES

Challenger's electric hydraulic cassette-style inground lift fleet meets the rigorous demands of professional service facilities. Lifts are available from 8,000 lb. to Challenger's industry-only 15,000 lb. lifting capacity. Inground lifts require less shop space than surface mounted lifts. With a smaller footprint, your shop will maximize the number of service bays, resulting in higher parts and service revenue. Also enjoy a professional, showroom-style appearance to make the best impression on every customer. Whether you're constructing a new facility or outfitting an existing building, we have an installation application to fit your needs.



8,000 LB



10,000 LB



12,000 LB



15,000 LB

**CL Challenger Lifts**

LOUISVILLE, KENTUCKY



10,000 LB.

12,000 LB.



## EV1020 / EV1220

- » Choose between 3-stage front and 3-stage rear arms or a drive-on fixed pad (EV1020 only) with two-way directional sliders to suit your service needs
- » 8.5" diameter chrome pistons provide greater stability under load
- » Chrome non-breathing ram style cylinder provides for longer lift life
- » Mechanical lock engages every 3" allowing ergonomic working height for technicians to increase productivity and minimize fatigue
- » Stainless steel air lock release cylinder promotes longer working life with its corrosion resistant design
- » Fully-contained and sealed recycled polymer cassette tub eliminates risk of hydraulic fluid seeping into the ground
- » 87" drive-thru accommodates wider vehicles, minimizes tire damage and provides for easy drive-on

## STANDARD TELESCOPING SCREW PADS

- » Challenger's telescoping screw pads makes access to vehicle lift points as simple as possible
- » Footpads can be screwed up or down to ensure level lifting in all conditions
- » More precise and secure frame engagement ensures technician safety



## PRODUCTIVITY UPGRADES

### QUICK CYCLE

- » A true express service solution
- » Decreases vehicle travel time by 30 percent

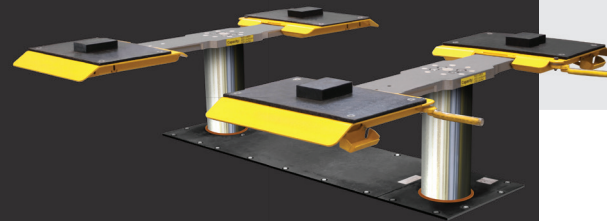

### EXPRESS PAD

- » 9,000 lb. capacity
- » Drive-on fixed pad with two-way directional sliders to suit your service needs
- » EV1020 only
- » ALI/ETL certified

15,000 LB.

INDUSTRY'S ONLY  
15K INGROUND



WIDE 8,000 LB.



## EV1520

- » Industry's only 15,000 lb. inground model
- » Heavy-duty 2-stage drive-over front and rear arms make for easy spotting
- » 8.5" diameter chrome pistons provide greater stability under load
- » Mechanical lock engages every 3" allowing ergonomic working height for technicians to increase productivity and minimize fatigue
- » Stainless steel air lock release cylinder promotes longer working life with its corrosion resistant design
- » Fully-contained and sealed recycled polymer cassette tub eliminates risk of hydraulic fluid seeping into the ground
- » Heavy-duty polyurethane screw pads accommodate a wide range of recommended lifting points

## EW0820

- » Chrome non-breathing ram style cylinder provides for longer lift life
- » Enhanced wiper at top and bottom of bearing provides better grease retention and minimizes contaminants from entering into bearings
- » Mechanical lock engages every 4" allowing ergonomic working height for technicians to increase productivity and minimize fatigue
- » Fully contained and sealed galvanized steel cassette tub eliminates risk of hydraulic fluid seeping into the ground
- » Widely spaced structure allows for a large, unobstructed workspace, especially useful for battery access on new electric vehicles

## STAYDRY

StayDry automatically removes any accumulated condensation from the floor of the lift containment system each time the lift operator lowers the lift. StayDry is pneumatically powered from the existing air supply. Part No. **SD100**



## EW0820 FOOTPADS

Challenger's EW0820 inground lift is designed to service electric and wide vehicles. For this reason, it comes equipped with Euro-friendly round rubber footpads. Part No. **B2260**





# OPTIONS & ACCESSORIES

## STANDARD ACCESSORIES



MODEL EV1020

Double telescoping footpads (4)

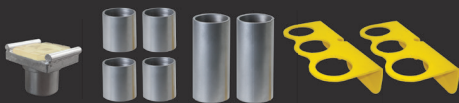

MODELS EV1220 / EV1520

Single telescoping heavy-duty footpads (4), 4" stack adapters (4), 8" stack adapters (2) and an organizer rack

## POWER CONTROL CONFIGURATIONS

Standard power control unit mounts to walls near workbenches. Inground lifts feature a single-push button lift function and down-release valve handle.



Optional bench mounted power controls include raise, lower and lock release functions. Controls mount to workbenches, providing convenient access to inground lift controls. Controls are also available in a lever option for no extra charge.

## OPTIONAL ACCESSORIES

### LIFTING POINT ACCESSORIES



3" stack adapter  
(sold individually)  
**B2206-3**



Pair of 6" stack adapters  
**10313**



Pair of frame engaging  
truck lift adapters  
**10314**



Stack adapter kit  
includes four 3"  
adapters, two 6"  
adapters, and two  
organizer racks with  
hardware  
**10315**



Stack organizer rack  
**10316**



Luxury car adapters  
**10300**

### HEAVY-DUTY LIFTING POINTS



Heavy-duty medium  
(4") stack adapter  
(sold individually)  
**B12069**



Heavy-duty tall (8")  
stack adapters  
(sold individually)  
**B12068**



Reducer bushing for use  
with 10318 (set of 4)  
For lift models 15000  
and 18000  
**10317**



Sprinter kit including  
pair of cradle adapters  
and pair of pin adapters  
**10333**

### RUBBER LIFTING POINTS



Optional round  
double telescoping  
rubber footpads  
for 10,000 lb.  
capacity lifts  
**B2260**



Set of 4 frame  
engaging truck lift  
adapters  
**10318**



Truck adapter and  
frame engaging  
adapter kit for  
rubber footpads  
**10319**

# CHALLENGER ADVANTAGE

## COMPLIMENTARY CAD SERVICES

Whether you're building a new facility or expanding, complete your plans with us. Challenger Lifts offers free CAD Layout Services to help you maximize your automotive lift installation (Six lift minimum for inquiry). Challenger Lifts' CAD services help decision makers visualize their shop layout in order to increase production and efficiency. With one of the most complete product lines in the industry, Challenger Lifts can provide the equipment and services to make your shop a profitable one. For more information, please contact Facility Layout Planning at 1-800-648-5438.

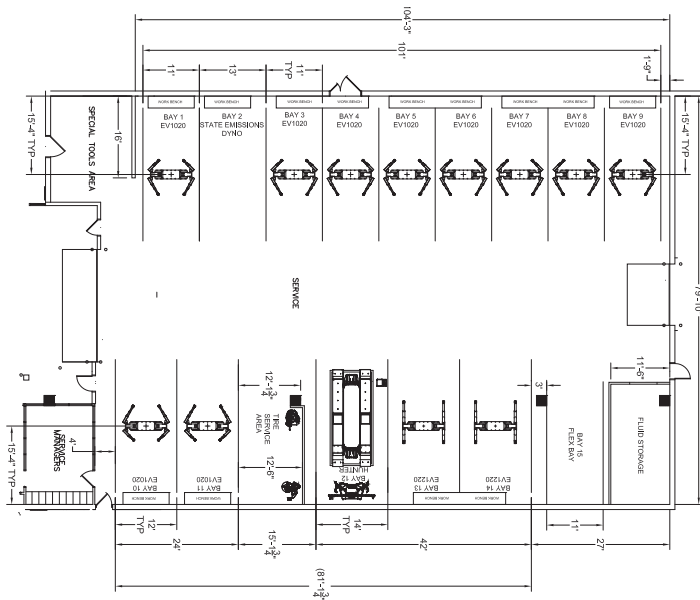

## INSTALLATION OPTIONS

A variety of installation applications are available. Work with Challenger to arrange installation around your construction schedule. Our inground lifts are sold as complete lifts, prekits, completion kits and superstructure-only. Select the installation option to support your future growth and eliminate costly and unsightly floor excavation.

## RETURN ON INVESTMENT INGROUND V. ABOVE GROUND

Secure a higher return on investment. Inground lifts take up less valuable shop space than their above-ground counterparts.

If your facility will fit 10 above-ground lifts, you can install 11 ingrounds. The additional service bay could be worth more than \$200,000 in annual parts and service sales.

An inground lift installation is a valuable investment in the future profitability of your facility.



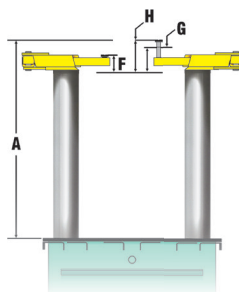
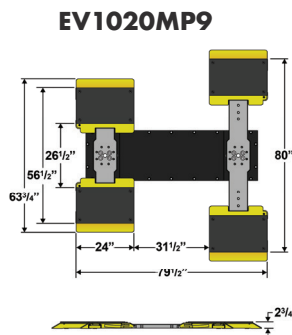

EV1020

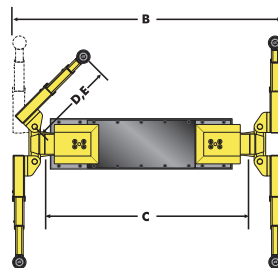

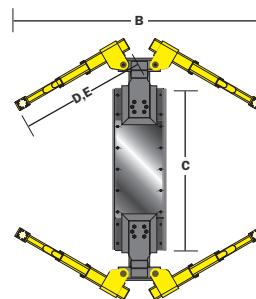

EV1220

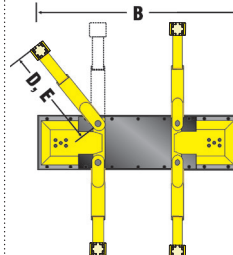

EV1520



MODEL NUMBER	EV1020MP9	EV1020MP9-QC	EV1020	EV1020-QC	EV1220	EV1220-QC	EV1520	EW0820
Lifting Capacity	9,000 lb.		10,000 lb.		12,000 lb.		15,000 lbs.	8,000 lbs.
Arms	Drive-on Express Pad		3-stage front/rear				2-stage front/rear	3-stage front/rear
Stroke			68"					73.25"
<b>A</b> Rise Height <sup>1</sup>	70.75"		74"		80.75"		84.25"	73.25"
<b>B</b> Width Overall	31.5" / 79.75"		97"		115"		71.5"	115.75"
<b>C</b> Drive-Thru Clearance	-		87"				-	102"
<b>D</b> Reach (Minimum)	-		19.625"				26.25"	25.25"
<b>E</b> Reach (Maximum)	-		42.125"		48"		43"	45.25"
<b>F</b> Rubber Pad Adapter Drive-Over Height (MP9)	2.75"		-		-		-	-
<b>G</b> Adj. Adapter Height <sup>2</sup> (with Medium Extensions)	-		6.875" - 9"		8" - 9.75"		10.5" - 12.75"	3.75" - 5.75"
<b>H</b> Adj. Adapter Height <sup>2</sup> (with High Extensions)	-		9.875" - 12"		11" - 12.75"		14.5" - 16.75"	-
Capacity (Per Arm/Pad)	2,250 lbs.		2,500 lbs.		3,000 lbs.		3,750 lbs.	2,000 lbs.
Guide Plunger Diameter			8.5"					5"
Motor	2HP	3HP	2HP	3HP	2HP	3HP	2HP	3HP
Voltage (Single Phase Std.) <sup>3</sup>	208v - 230v							
Speed of Rise	38 s	27 s	38 s	27 s	60 s	38s	77 s	38 s
Air Required	90 - 120 psi							75-125 psi
Recom. Bay Height	12' minimum							
ALI/ETL Certified	✓	✓	✓	✓	✓		✓	✓
Super Structure Colors								

<sup>1</sup> Rise height is measured with superstructure in highest position. <sup>2</sup> Medium and high stack adapter extensions are standard with EV1220 and EV1520, optional with EV1020. <sup>3</sup> Optional 3 phase power unit also available, please specify at time of order. † Frame engaging adapters (10314 or 10318) are REQUIRED when lifting vehicles with frame construction.

For more information, contact your Authorized Challenger Lifts Distributor:

800-648-5438 | 502-625-0700 | Fax: 502-625-0711 | Email: sales@challengerlifts.com  
2311 South Park Road | Louisville, KY 40219



Challenger Lifts, Inc. reserves the right to make changes to specifications without notice and without making changes retroactive. Unloading, installation and oil not included.